

## Chelsea Benner

---

**From:** Heather Hazlett <HHazlett@lwhsd.com>  
**Sent:** Tuesday, June 07, 2016 4:23 PM  
**To:** CDS User  
**Cc:** Jeff Slothower  
**Subject:** Project File No.: CU-15-00006 - Letter from Jeff Slothower Attached  
**Attachments:** 20160607161206.pdf

Please open the attached PDF file, which contains a letter from Jeff Slothower of today's date.

**Heather L. Hazlett**

Legal Assistant to Jeff Slothower  
Lathrop, Winbauer, Harrel, Slothower & Denison L.L.P.  
P.O. Box 1088  
Ellensburg, WA 98926

Phone 509.925.6916  
Fax 509.343.3206

Notice: This e-mail message and its attachments are confidential and/or attorney work product and subject to the attorney-client communication privilege. This e-mail is being transmitted to and is intended only for the use of the recipient named above. If you have received this e-mail in error, please immediately notify the sender by reply e-mail and delete and/or destroy the original and all copies of the e-mail.

Attachment Disclaimer: If this email has an attachment(s) Heather Hazlett and Lathrop, Winbauer, Harrel, Slothower & Denison L.L.P. take no responsibility for changes, alterations or modifications of the attachment(s) by the intended recipient of the attachment or others after this email leaves the Lathrop, Winbauer, Harrel, Slothower & Denison L.L.P. email server.

**Planners Note: This comment letter was emailed as noted above; the original hard copy was hand delivered the following day.**

# Lathrop, Winbauer, Harrel, Slothower & Denison L.L.P.

Attorneys at Law

Post Office Box 1088, 201 West Seventh Avenue, Ellensburg, WA 98926

F. Steven Lathrop, P.S.  
John P. Winbauer  
Susan K. Harrel  
Jeff Slothower  
James T. Denison, Jr.  
Douglas W. Nicholson

Jeff Slothower  
jslothower@lwbsd.com

Tel (509) 925-6916  
Direct Fax (509) 343-3206  
www.lwbsd.com

June 7, 2016

## Sent Via Email and Hand Delivery

[cds@co.kittitas.wa.us](mailto:cds@co.kittitas.wa.us)

Kittitas County Community Development Services  
411 N Ruby Street, Suite 2  
Ellensburg WA 98926

**Re: Project File No.: CU-15-00006**

**Project Name: Iron Horse**

**Applicant: OneEnergy Development LLC, authorized agent for Bill Hanson, landowner**

To Whom It May Concern:

The undersigned represents the Kittitas Reclamation District ("KRD"). The KRD has a right-of-way, described on Exhibit A. The right-of-way is adjacent to the boundary of the above-identified project.

No portion of the KRD's right-of-way is on the property that is the subject of this application but the KRD right-of-way has a road built on it that runs immediately adjacent with and parallel to the project boundary.

No use can be made of the KRD right-of-way by the Applicant in either the construction and/or operation of the proposed solar power generating facilities.

If you have any questions or concerns, please contact me or Urban Eberhart, Secretary/Manager of the KRD.

Very truly yours,



Jeff Slothower

JS:hh

cc: Clients (via email, w/encls.)

Section 1, T17N, R19E, W4.

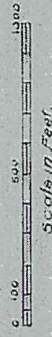
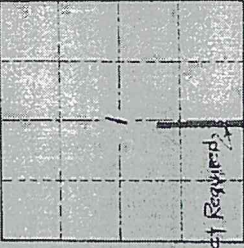

Catherine Faust  
 E $\frac{1}{2}$  SW $\frac{1}{4}$  Sec 1, T. 17N, R. 19E, W. 4.  
 310 ACRES

DEPARTMENT OF THE INTERIOR  
 BUREAU OF RECLAMATION  
 YAKIMA PROJECT, WASH.  
 KITTITAS DIVISION  
 W. CAMPAL WASTEWAY - R. O. W.  
 DRAWN BY: B. H. CONNOR  
 CHECKED BY: APPROVED:  
 423-235



Catherine Faust  
 087A

Caribou Creek

Catherine Faust  
 223A

N. 89° 59' W. 2732.4'

2 1 11 12

# Lathrop, Winbauer, Harrel, Slothower & Denison L.L.P.

Attorneys at Law

Post Office Box 1088, 201 West Seventh Avenue, Ellensburg, WA 98926

F. Steven Lathrop, P.S.  
John P. Winbauer  
Susan K. Harrel  
Jeff Slothower  
James T. Denison, Jr.  
Douglas W. Nicholson

Jeff Slothower  
jslothower@lwbsd.com

Tel (509) 925-6916  
Direct Fax (509) 343-3206  
www.lwbsd.com

June 7, 2016

**Sent Via Email and Hand Delivery**  
[cds@co.kittitas.wa.us](mailto:cds@co.kittitas.wa.us)

Kittitas County Community Development Services  
411 N Ruby Street, Suite 2  
Ellensburg WA 98926

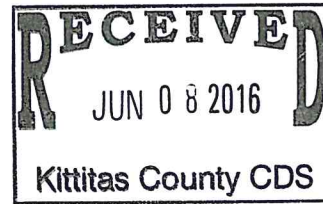

**Re: Project File No.: CU-15-00006**  
**Project Name: Iron Horse**  
**Applicant: OneEnergy Development LLC, authorized agent for Bill Hanson, landowner**

To Whom It May Concern:

The undersigned represents the Kittitas Reclamation District ("KRD"). The KRD has a right-of-way, described on Exhibit A. The right-of-way is adjacent to the boundary of the above-identified project.

No portion of the KRD's right-of-way is on the property that is the subject of this application but the KRD right-of-way has a road built on it that runs immediately adjacent with and parallel to the project boundary.

No use can be made of the KRD right-of-way by the Applicant in either the construction and/or operation of the proposed solar power generating facilities.

If you have any questions or concerns, please contact me or Urban Eberhart, Secretary/Manager of the KRD.

Very truly yours,

A handwritten signature in blue ink, appearing to read "JS", written over the printed name "Jeff Slothower".

Jeff Slothower

JS:hh

cc: Clients (via email, w/encls.)

Section 1, T.17N., R.19E., W.M.

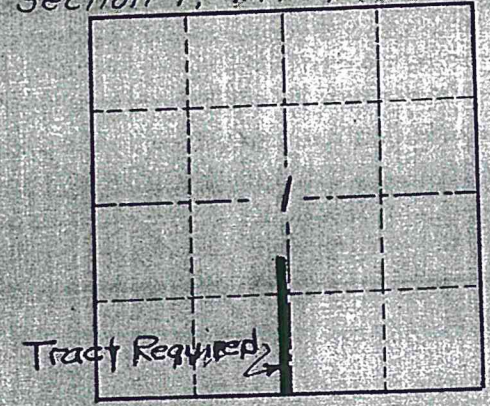

T.17N.  
R.19E.

Catherine Faust  
0.87A

Caribou Creek

70'

Catherine Faust  
2.23A

35'

S. of Caribou Wasteway

300'

Road fence?

100'

N. 89° 59' W. 2732.4'

2 1  
11 12

N

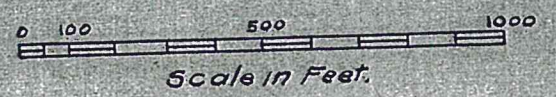

Catherine Faust  
E 1/2 S.W. 1/4 Sec. 1, T.17N., R.19E., W.M.  
3.10 Acres

DEPARTMENT OF THE INTERIOR  
BUREAU OF RECLAMATION  
YAKIMA PROJECT, WASH.  
KITITAS DIVISION  
NB. CANAL WASTEWAY - F.O.W.  
DRAWN: F.L.B. RECOMMENDED: .....  
CHECKED: ..... APPROVED: .....  
42B-235 Ellensburg, Wash.